

CATALOG

OEM Fiber Coupled Diode Laser System





WAVESPECTRUM GROUP was founded in 1999. It is comprised by a group of experienced and innovative experts in the fields of laser physics, materials science, electronic technology and mechanical design. It has established solid cooperation with some famous universities, research institutes and laboratories.

Wavespectrum products are widely used in space science, optical communication technology, laser display, laser medical, life sciences and materials processing. With the rapid development, R&D centers and production bases have been established in China and Europe. The current plant area is 4,000 square meters, including 2,000 square meters of Class 1,000 clean workshops.

Wavespectrum products include laser diodes, fiber-coupled laser modules and fiber-coupled laser systems with wavelengths from 405nm to 1920nm. Our products are used in medical, printing, laser display, life science, laser communication and other fields. At present, the products have all passed the certifications of ROHS, REACH, CE, etc. At the same time, we have got ISO90001 quality management system certification.

Wavespectrum has world-class R&D team, and it has the world first-class production processing plants. Our products can meet the military-grade production and design standards. The products are well acclaimed world-wide, such in Germany, Austria, the United States, Japan, South Korea and other parts of the world. We have established close cooperation with a number of well-known enterprises world-wide.

Wavespectrum offers laser products with wavelength ranges from 405nm to 1920nm.

405nm	445nm	465nm	488nm	505nm	515nm	520nm	525nm	635nm	650nm	660nm	670nm	680nm
685nm	760nm	785nm	790nm	808nm	830nm	850nm	860nm	880nm	905nm	915nm	940nm	980nm
1064nm	1210nm	1270nm	1280nm	1290nm	1310nm	1330nm	1350nm	1370nm	1390nm	1410nm	1430nm	1450nm
1470nm	1490nm	1510nm	1530nm	1550nm	1570nm	1590nm	1610nm	1625nm	1650nm	1720nm	1900nm	1920nm

CONTACT US

Wavespectrum Laser Group Limited

Address : 2-2-1504, 2# Haitai Innovation 6th Road, Xiqing Dist, 300392, TianJin, China

Web : www.wavespectrum-laser.com.cn Email : sales@wavespectrum-laser.com.cn

Tel : 86-022-87931118 Fax : 86-022-86392109

Distributors Wanted World-Wide!

PRODUCT CONTENTS

Single Mode Fiber
Coupled Laser Diode



Multi-mode Fiber Coupled
Laser Module



Single Mode Laser Diode



Multi-mode Laser Diode

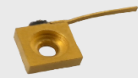

Collimated Laser Diode



Turnkey Fiber Coupled
Diode Laser System



OEM Fiber Coupled Diode
Laser System



Fiber Receptacle Laser
Module



405nm High Power Fiber
Coupled Laser Source



405nm Fiber Receptacle
Laser Module



Red & Green Aiming Beam
for Fiber Laser



Triplex (RGB) Fiber Coupled
White Laser Module



Triplex (RGB) Fiber Coupled
White Laser System



3-wavelength (Multi-
wavelength) Fiber Coupled
Laser System



3-channel (Multi-channel)
Fiber Coupled Laser System



Multi-wavelength Fiber
Coupled Laser Module



High Power Fiber
Bundled Laser Module



Photodiode



OEM Fiber Coupled Diode Laser System

PRODUCT FEATURE

405nm~1920nm
 OEM Laser System
 Integrated Package Size
 SMF/PMF/MMF Optional
 1mW~12W Output Power
 Built-in TE Cooling & Driver
 5V/12V /24V DC Input
 TTL/Analog Modulation
 Long Lifetime
 High Stability
 Customized Wavelength/Power/Fiber Type



PRODUCT OVERVIEW

OEM Fiber Coupled Diode Laser System is the most competitive product of WAVESPECTRUM.

We offer 405nm~1920nm Fiber Coupled Laser Source with Single Mode Fiber (SMF), Multimode Fiber (MMF) and Polarization Maintaining Fiber (PMF) . The Output Power is from 1mW to 12W.

The OEM Fiber Coupled Diode Laser System contains the Fiber Coupled Laser Module, LD Driver and Temperature Control System. It is with integrated package design and small size. Just need Input 5V/12V/24V DC can work the Laser Source, it is easy to use. To ensure the long-time reliability and power stability, each Laser System will undergo rigorous testing and aging in factory.



Wavelength	Part Number	Output Power Range	Fiber Type	Fiber Core	Supply Voltage	Connector	TEC	Analog	TTL
405nm	WSLS-405-015m-4-DC	0 ~ 15mW	SM	3um	7.5VDC	FC/SMA	√	○	○
	WSLS-405-030m-4-DC	0 ~ 30mW	SM	3um	7.5VDC	FC/SMA	√	○	○
	WSLS-405-050m-4-DC	0 ~ 50mW	SM	3um	7.5VDC	FC/SMA	√	○	○
	WSLS-405-080m-4-DC	0 ~ 80mW	SM	3um	7.5VDC	FC/SMA	√	○	○
	WSLS-405-100m-4-DC	0 ~ 100mW	SM	3um	7.5VDC	FC/SMA	√	○	○
	WSLS-405-015m-PM-DC	0 ~ 15mW	PM	3um	7.5VDC	FC	√	○	○
	WSLS-405-030m-PM-DC	0 ~ 30mW	PM	3um	7.5VDC	FC	√	○	○
	WSLS-405-050m-PM-DC	0 ~ 50mW	PM	3um	7.5VDC	FC	√	○	○
	WSLS-405-080m-PM-DC	0 ~ 80mW	PM	3um	7.5VDC	FC	√	○	○
	WSLS-405-100m-PM-DC	0 ~ 100mW	PM	3um	7.5VDC	FC	√	○	○
	WSLS-405-200m-M-DC	0 ~ 200mW	MM	105um	7.5VDC	FC/SMA	√	○	○
	WSLS-405-300m-M-DC	0 ~ 300mW	MM	105um	7.5VDC	FC/SMA	√	○	○
	WSLS-405-1200m-M-DC	0 ~ 1.2W	MM	<400um	24VDC	FC/SMA	√	○	○
	WSLS-405-002-M-DC	0 ~ 2W	MM	<400um	24VDC	FC/SMA	√	○	○
	WSLS-405-005-M-DC	0 ~ 5W	MM	<650um	24VDC	FC/SMA	NO	○	○
WSLS-405-010-M-DC	0 ~ 10W	MM	<1000um	24VDC	FC/SMA	NO	○	○	
445nm	WSLS-445-020m-4-DC	0 ~ 20mW	SM	3um	7.5VDC	FC/SMA	√	○	○
	WSLS-445-030m-4-DC	0 ~ 30mW	SM	3um	7.5VDC	FC/SMA	√	○	○
	WSLS-445-040m-4-DC	0 ~ 40mW	SM	3um	7.5VDC	FC/SMA	√	○	○
	WSLS-445-020m-PM-DC	0 ~ 20mW	PM	3um	7.5VDC	FC	√	○	○
	WSLS-445-030m-PM-DC	0 ~ 30mW	PM	3um	7.5VDC	FC	√	○	○
	WSLS-445-050m-M-DC	0 ~ 50mW	MM	50um	7.5VDC	FC/SMA	√	○	○
	WSLS-445-001-M-DC	0 ~ 1W	MM	105um	7.5VDC	FC/SMA	√	○	○
WSLS-445-3500m-M-DC	0 ~ 3.5W	MM	200um	7.5VDC	FC/SMA	√	○	○	
465nm	WSLS-465-002-M-DC	0 ~ 2W	MM	105um	7.5VDC	FC/SMA	√	○	○
488nm	WSLS-488-015m-4-DC	0 ~ 15mW	SM	3um	7.5VDC	FC/SMA	√	○	○
	WSLS-488-020m-4-DC	0 ~ 20mW	SM	3um	7.5VDC	FC/SMA	√	○	○
	WSLS-488-015m-PM-DC	0 ~ 15mW	PM	3um	7.5VDC	FC	√	○	○
	WSLS-488-020m-PM-DC	0 ~ 20mW	PM	3um	7.5VDC	FC	√	○	○
	WSLS-488-040m-M-DC	0 ~ 40mW	MM	105um	7.5VDC	FC/SMA	√	○	○
505nm	WSLS-505-010m-4-DC	0 ~ 10mW	SM	3um	7.5VDC	FC/SMA	√	○	○
	WSLS-505-020m-4-DC	0 ~ 20mW	SM	3um	7.5VDC	FC/SMA	√	○	○
	WSLS-505-010m-PM-DC	0 ~ 10mW	PM	3um	7.5VDC	FC	√	○	○
	WSLS-505-020m-PM-DC	0 ~ 20mW	PM	3um	7.5VDC	FC	√	○	○
	WSLS-505-030m-M-DC	0 ~ 30mW	MM	105um	7.5VDC	FC/SMA	√	○	○
	WSLS-505-050m-M-DC	0 ~ 50mW	MM	105um	7.5VDC	FC/SMA	√	○	○
520nm	WSLS-520-010m-4-DC	0 ~ 10mW	SM	3um	7.5VDC	FC/SMA	√	○	○
	WSLS-520-020m-4-DC	0 ~ 20mW	SM	3um	7.5VDC	FC/SMA	√	○	○
	WSLS-520-025m-4-DC	0 ~ 25mW	SM	3um	7.5VDC	FC/SMA	√	○	○
	WSLS-520-010m-PM-DC	0 ~ 10mW	PM	3um	7.5VDC	FC	√	○	○

Note: √:Yes, ○:Optional, x:No.

Wavelength	Part Number	Output Power Range	Fiber Type	Fiber Core	Supply Voltage	Connector	TEC	Analog	TTL
520nm	WSLS-520-020m-PM-DC	0 ~ 20mW	PM	3um	7.5VDC	FC	√	○	○
	WSLS-520-025m-PM-DC	0 ~ 25mW	PM	3um	7.5VDC	FC	√	○	○
	WSLS-520-050m-M-DC	0 ~ 50mW	MM	105um	7.5VDC	FC/SMA	√	○	○
	WSLS-520-700m-M-DC	0 ~ 700mW	MM	105um	7.5VDC	FC/SMA	√	○	○
525nm	WSLS-525-700m-M-DC	0 ~ 700mW	MM	105um	7.5VDC	FC/SMA	√	○	○
635nm	WSLS-635-030m-4-DC	0 ~ 30mW	SM	4um	5VDC	FC/SMA	√	○	○
	WSLS-635-050m-4-DC	0 ~ 50mW	SM	4um	5VDC	FC/SMA	√	○	○
	WSLS-635-070m-4-DC	0 ~ 70mW	SM	4um	5VDC	FC/SMA	√	○	○
	WSLS-635-030m-PM-DC	0 ~ 30mW	PM	4um	5VDC	FC	√	○	○
	WSLS-635-050m-PM-DC	0 ~ 50mW	PM	4um	5VDC	FC	√	○	○
	WSLS-635-070m-PM-DC	0 ~ 70mW	PM	4um	5VDC	FC	√	○	○
	WSLS-635-100m-M-DC	0 ~ 100mW	MM	105um	5VDC	FC/SMA	√	○	○
	WSLS-635-300m-M-DC	0 ~ 300mW	MM	105um	5VDC	FC/SMA	√	○	○
	WSLS-635-001-M-DC	0 ~ 1W	MM	105um	5VDC	FC/SMA	√	○	○
	WSLS-635-1800m-M-DC	0 ~ 1.8W	MM	200um	5VDC	FC/SMA	√	○	○
658nm	WSLS-650-050m-4-DC	0 ~ 50mW	SM	4um	5VDC	FC/SMA	√	○	○
	WSLS-650-080m-4-DC	0 ~ 80mW	SM	4um	5VDC	FC/SMA	√	○	○
	WSLS-650-100m-4-DC	0 ~ 100mW	SM	4um	5VDC	FC/SMA	√	○	○
	WSLS-650-030m-PM-DC	0 ~ 30mW	PM	4um	5VDC	FC	√	○	○
	WSLS-650-050m-PM-DC	0 ~ 50mW	PM	4um	5VDC	FC	√	○	○
	WSLS-650-080m-PM-DC	0 ~ 80mW	PM	4um	5VDC	FC	√	○	○
	WSLS-650-100m-M-DC	0 ~ 100mW	MM	105um	5VDC	FC/SMA	√	○	○
	WSLS-650-700m-M-DC	0 ~ 700mW	MM	105um	5VDC	FC/SMA	√	○	○
670nm	WSLS-670-003m-4-DC	0 ~ 3mW	SM	3um	5VDC	FC/SMA	√	○	○
	WSLS-670-005m-4-DC	0 ~ 5mW	SM	3um	5VDC	FC/SMA	√	○	○
	WSLS-670-003m-PM-DC	0 ~ 3mW	PM	3um	5VDC	FC	√	○	○
	WSLS-670-005m-PM-DC	0 ~ 5mW	PM	3um	5VDC	FC	√	○	○
680nm	WSLS-680-700m-M-DC	0 ~ 700mW	MM	105um	5VDC	FC/SMA	√	○	○
685nm	WSLS-685-010m-4-DC	0 ~ 10mW	SM	4um	5VDC	FC/SMA	√	○	○
	WSLS-685-015m-4-DC	0 ~ 15mW	SM	4um	5VDC	FC/SMA	√	○	○
	WSLS-685-010m-PM-DC	0 ~ 10mW	PM	4um	5VDC	FC	√	○	○
	WSLS-685-015m-PM-DC	0 ~ 15mW	PM	4um	5VDC	FC	√	○	○
	WSLS-685-030m-M-DC	0 ~ 30mW	MM	105um	5VDC	FC/SMA	√	○	○
760nm	WSLS-760-1500m-M-DC	0 ~ 1.5W	MM	105um	5VDC	FC/SMA	√	○	○
785nm	WSLS-785-030m-4-DC	0 ~ 30mW	SM	5um	5VDC	FC/SMA	√	○	○
	WSLS-785-040m-4-DC	0 ~ 40mW	SM	5um	5VDC	FC/SMA	√	○	○
	WSLS-785-030m-PM-DC	0 ~ 30mW	PM	5um	5VDC	FC	√	○	○
	WSLS-785-040m-PM-DC	0 ~ 40mW	PM	5um	5VDC	FC	√	○	○
	WSLS-785-003-M-DC	0 ~ 3W	MM	105um	5VDC	FC/SMA	√	○	○
808nm	WSLS-808-030m-4-DC	0 ~ 30mW	SM	5um	5VDC	FC/SMA	√	○	○

Note: √:Yes, ○:Optional, ×:No.

Wavelength	Part Number	Output Power Range	Fiber Type	Fiber Core	Supply Voltage	Connector	TEC	Analog	TTL
808nm	WSLS-808-050m-4-DC	0 ~ 50mW	SM	5um	5VDC	FC/SMA	√	○	○
	WSLS-808-020m-PM-DC	0 ~ 20mW	PM	5um	5VDC	FC	√	○	○
	WSLS-808-040m-PM-DC	0 ~ 40mW	PM	5um	5VDC	FC	√	○	○
	WSLS-808-150m-M-DC	0 ~ 150mW	MM	105um	5VDC	FC/SMA	√	○	○
	WSLS-808-002-M-DC	0 ~ 2W	MM	105um	5VDC	FC/SMA	√	○	○
	WSLS-808-003-M-DC	0 ~ 3W	MM	105um	5VDC	FC/SMA	√	○	○
	WSLS-808-004-M-DC	0 ~ 4W	MM	105um	12VDC	FC/SMA	√	○	○
	WSLS-808-005-M-DC	0 ~ 5W	MM	105um	12VDC	FC/SMA	√	○	○
	WSLS-808-007-M-DC	0 ~ 7W	MM	105um	12VDC	FC/SMA	√	○	○
830nm	WSLS-830-030m-4-DC	0 ~ 30mW	SM	5um	5VDC	FC/SMA	√	○	○
	WSLS-830-050m-4-DC	0 ~ 50mW	SM	5um	5VDC	FC/SMA	√	○	○
	WSLS-830-080m-4-DC	0 ~ 80mW	SM	5um	5VDC	FC/SMA	√	○	○
	WSLS-830-100m-4-DC	0 ~ 100mW	SM	5um	5VDC	FC/SMA	√	○	○
	WSLS-830-030m-PM-DC	0 ~ 30mW	PM	5um	5VDC	FC	√	○	○
	WSLS-830-050m-PM-DC	0 ~ 50mW	PM	5um	5VDC	FC	√	○	○
	WSLS-830-080m-PM-DC	0 ~ 80mW	PM	5um	5VDC	FC	√	○	○
	WSLS-830-100m-PM-DC	0 ~ 100mW	PM	5um	5VDC	FC	√	○	○
	WSLS-830-120m-M-DC	0 ~ 120mW	MM	105um	5VDC	FC/SMA	√	○	○
	WSLS-830-001-M-DC	0 ~ 1W	MM	50um	5VDC	FC/SMA	√	○	○
	WSLS-830-002-M-DC	0 ~ 2W	MM	105um	5VDC	FC/SMA	√	○	○
	WSLS-830-003-M-DC	0 ~ 3W	MM	105um	5VDC	FC/SMA	√	○	○
850nm	WSLS-850-030m-4-DC	0 ~ 30mW	SM	5um	5VDC	FC/SMA	√	○	○
	WSLS-850-050m-4-DC	0 ~ 50mW	SM	5um	5VDC	FC/SMA	√	○	○
	WSLS-850-070m-4-DC	0 ~ 70mW	SM	5um	5VDC	FC/SMA	√	○	○
	WSLS-850-030m-PM-DC	0 ~ 30mW	PM	5um	5VDC	FC	√	○	○
	WSLS-850-050m-PM-DC	0 ~ 50mW	PM	5um	5VDC	FC	√	○	○
	WSLS-850-070m-PM-DC	0 ~ 70mW	PM	5um	5VDC	FC	√	○	○
	WSLS-850-120m-M-DC	0 ~ 120mW	MM	105um	5VDC	FC/SMA	√	○	○
860nm	WSLS-860-002-M-DC	0 ~ 2W	MM	105um	5VDC	FC/SMA	√	○	○
880nm	WSLS-880-002m-4-DC	0 ~ 2mW	SM	5um	5VDC	FC/SMA	√	○	○
	WSLS-880-002m-PM-DC	0 ~ 2mW	PM	5um	5VDC	FC	√	○	○
	WSLS-880-002-M-DC	0 ~ 2W	MM	105um	5VDC	FC/SMA	√	○	○
	WSLS-880-003-M-DC	0 ~ 3W	MM	105um	5VDC	FC/SMA	√	○	○
905nm	WSLS-905-020m-4-DC	0 ~ 20mW	SM	5um	5VDC	FC/SMA	√	○	○
	WSLS-905-030m-4-DC	0 ~ 30mW	SM	5um	5VDC	FC/SMA	√	○	○
	WSLS-905-020m-PM-DC	0 ~ 20mW	PM	5um	5VDC	FC	√	○	○
	WSLS-905-030m-PM-DC	0 ~ 30mW	PM	5um	5VDC	FC	√	○	○
	WSLS-905-050m-M-DC	0 ~ 50mW	MM	105um	5VDC	FC/SMA	√	○	○
915nm	WSLS-915-002-M-DC	0 ~ 2W	MM	105um	5VDC	FC/SMA	√	○	○
	WSLS-915-010-M-DC	0 ~ 10W	MM	105um	12VDC	FC/SMA	√	○	○

Note: √:Yes, ○:Optional, ×:No.

Wavelength	Part Number	Output Power Range	Fiber Type	Fiber Core	Supply Voltage	Connector	TEC	Analog	TTL
915nm	WSLS-915-012-M-DC	0 ~ 12W	MM	105um	12VDC	FC/SMA	√	○	○
940nm	WSLS-940-030m-4-DC	0 ~ 30mW	SM	5um	5VDC	FC/SMA	√	○	○
	WSLS-940-050m-4-DC	0 ~ 50mW	SM	5um	5VDC	FC/SMA	√	○	○
	WSLS-940-070m-4-DC	0 ~ 70mW	SM	5um	5VDC	FC/SMA	√	○	○
	WSLS-940-030m-PM-DC	0 ~ 30mW	PM	5um	5VDC	FC	√	○	○
	WSLS-940-050m-PM-DC	0 ~ 50mW	PM	5um	5VDC	FC	√	○	○
	WSLS-940-070m-PM-DC	0 ~ 70mW	PM	5um	5VDC	FC	√	○	○
	WSLS-940-100m-M-DC	0 ~ 100mW	MM	105um	5VDC	FC/SMA	√	○	○
	WSLS-940-002-M-DC	0 ~ 2W	MM	105um	5VDC	FC/SMA	√	○	○
	WSLS-940-010-M-DC	0 ~ 10W	MM	105um	12VDC	FC/SMA	√	○	○
	WSLS-940-012-M-DC	0 ~ 12W	MM	105um	12VDC	FC/SMA	√	○	○
980nm	WSLS-980-010m-4-DC	0 ~ 10mW	SM	6um	5VDC	FC/SMA	√	○	○
	WSLS-980-020m-4-DC	0 ~ 20mW	SM	6um	5VDC	FC/SMA	√	○	○
	WSLS-980-100m-M-DC	0 ~ 100mW	MM	105um	5VDC	FC/SMA	√	○	○
	WSLS-980-002-M-DC	0 ~ 2W	MM	105um	5VDC	FC/SMA	√	○	○
	WSLS-980-010-M-DC	0 ~ 10W	MM	105um	12VDC	FC/SMA	√	○	○
	WSLS-980-012-M-DC	0 ~ 12W	MM	105um	12VDC	FC/SMA	√	○	○
1064nm	WSLS-1064-010m-4-DC	0 ~ 10mW	SM	6um	5VDC	FC/SMA	√	○	○
	WSLS-1064-030m-4-DC	0 ~ 30mW	SM	6um	5VDC	FC/SMA	√	○	○
	WSLS-1064-050m-4-DC	0 ~ 50mW	SM	6um	5VDC	FC/SMA	√	○	○
	WSLS-1064-010m-PM-DC	0 ~ 10mW	PM	5um	5VDC	FC	√	○	○
	WSLS-1064-030m-PM-DC	0 ~ 30mW	PM	5um	5VDC	FC	√	○	○
	WSLS-1064-050m-PM-DC	0 ~ 50mW	PM	5um	5VDC	FC	√	○	○
	WSLS-1064-001-M-DC	0 ~ 1W	MM	105um	5VDC	FC/SMA	√	○	○
	WSLS-1064-007-M-DC	0 ~ 7W	MM	105um	12VDC	FC/SMA	√	○	○
1210nm	WSLS-1210-001-M-DC	0 ~ 1W	MM	105um	5VDC	FC/SMA	√	○	○
1270nm	WSLS-1270-005m-9-DC	0 ~ 5mW	SM	9um	5VDC	FC/SMA	√	○	○
	WSLS-1270-005m-PM-DC	0 ~ 5mW	PM	9um	5VDC	FC	√	○	○
1280nm	WSLS-1280-001-M-DC	0 ~ 1W	MM	105um	5VDC	FC/SMA	√	○	○
1290nm	WSLS-1290-005m-9-DC	0 ~ 5mW	SM	9um	5VDC	FC/SMA	√	○	○
	WSLS-1290-005m-PM-DC	0 ~ 5mW	PM	9um	5VDC	FC	√	○	○
1310nm	WSLS-1310-005m-9-DC	0 ~ 5mW	SM	9um	5VDC	FC/SMA	√	○	○
	WSLS-1310-010m-9-DC	0 ~ 10mW	SM	9um	5VDC	FC/SMA	√	○	○
	WSLS-1310-015m-9-DC	0 ~ 15mW	SM	9um	5VDC	FC/SMA	√	○	○
	WSLS-1310-005m-PM-DC	0 ~ 5mW	PM	9um	5VDC	FC	√	○	○
	WSLS-1310-010m-PM-DC	0 ~ 10mW	PM	9um	5VDC	FC	√	○	○
	WSLS-1310-015m-PM-DC	0 ~ 15mW	PM	9um	5VDC	FC	√	○	○
	WSLS-1310-001-M-DC	0 ~ 1W	MM	105um	5VDC	FC/SMA	√	○	○
1330nm	WSLS-1330-005m-9-DC	0 ~ 5mW	SM	9um	5VDC	FC/SMA	√	○	○
	WSLS-1330-005m-PM-DC	0 ~ 5mW	PM	9um	5VDC	FC	√	○	○

Note: √:Yes, ○:Optional, ×:No.

Wavelength	Part Number	Output Power Range	Fiber Type	Fiber Core	Supply Voltage	Connector	TEC	Analog	TTL
1330nm	WSLS-1330-001-M-DC	0 ~ 1W	MM	105um	5VDC	FC/SMA	√	○	○
1350nm	WSLS-1350-005m-9-DC	0 ~ 5mW	SM	9um	5VDC	FC/SMA	√	○	○
	WSLS-1350-005m-PM-DC	0 ~ 5mW	PM	9um	5VDC	FC	√	○	○
1370nm	WSLS-1370-005m-9-DC	0 ~ 5mW	SM	9um	5VDC	FC/SMA	√	○	○
	WSLS-1370-005m-PM-DC	0 ~ 5mW	PM	9um	5VDC	FC	√	○	○
1390nm	WSLS-1390-005m-9-DC	0 ~ 5mW	SM	9um	5VDC	FC/SMA	√	○	○
	WSLS-1390-005m-PM-DC	0 ~ 5mW	PM	9um	5VDC	FC	√	○	○
1410nm	WSLS-1410-005m-9-DC	0 ~ 5mW	SM	9um	5VDC	FC/SMA	√	○	○
	WSLS-1410-005m-PM-DC	0 ~ 5mW	PM	9um	5VDC	FC	√	○	○
1430nm	WSLS-1430-005m-9-DC	0 ~ 5mW	SM	9um	5VDC	FC/SMA	√	○	○
	WSLS-1430-005m-PM-DC	0 ~ 5mW	PM	9um	5VDC	FC	√	○	○
1450nm	WSLS-1450-005m-9-DC	0 ~ 5mW	SM	9um	5VDC	FC/SMA	√	○	○
	WSLS-1450-005m-PM-DC	0 ~ 5mW	PM	9um	5VDC	FC	√	○	○
	WSLS-1450-002-M-DC	0 ~ 2W	MM	105um	12VDC	FC/SMA	√	○	○
1470nm	WSLS-1470-005m-9-DC	0 ~ 5mW	SM	9um	5VDC	FC/SMA	√	○	○
	WSLS-1470-005m-PM-DC	0 ~ 5mW	PM	9um	5VDC	FC	√	○	○
	WSLS-1470-001-M-DC	0 ~ 1W	MM	105um	5VDC	FC/SMA	√	○	○
	WSLS-1470-002-M-DC	0 ~ 2W	MM	105um	12VDC	FC/SMA	√	○	○
1490nm	WSLS-1490-005m-9-DC	0 ~ 5mW	SM	9um	5VDC	FC/SMA	√	○	○
	WSLS-1490-005m-PM-DC	0 ~ 5mW	PM	9um	5VDC	FC	√	○	○
	WSLS-1490-002-M-DC	0 ~ 2W	MM	105um	12VDC	FC/SMA	√	○	○
1510nm	WSLS-1510-005m-9-DC	0 ~ 5mW	SM	9um	5VDC	FC/SMA	√	○	○
	WSLS-1510-005m-PM-DC	0 ~ 5mW	PM	9um	5VDC	FC	√	○	○
1530nm	WSLS-1530-005m-9-DC	0 ~ 5mW	SM	9um	5VDC	FC/SMA	√	○	○
	WSLS-1530-005m-PM-DC	0 ~ 5mW	PM	9um	5VDC	FC	√	○	○
	WSLS-1530-002-M-DC	0 ~ 2W	MM	105um	12VDC	FC/SMA	√	○	○
1550nm	WSLS-1550-005m-9-DC	0 ~ 5mW	SM	9um	5VDC	FC/SMA	√	○	○
	WSLS-1550-008m-9-DC	0 ~ 8mW	SM	9um	5VDC	FC/SMA	√	○	○
	WSLS-1550-010m-9-DC	0 ~ 10mW	SM	9um	5VDC	FC/SMA	√	○	○
	WSLS-1550-005m-PM-DC	0 ~ 5mW	PM	9um	5VDC	FC	√	○	○
	WSLS-1550-008m-PM-DC	0 ~ 8mW	PM	9um	5VDC	FC	√	○	○
	WSLS-1550-010m-PM-DC	0 ~ 10mW	PM	9um	5VDC	FC	√	○	○
	WSLS-1550-002-M-DC	0 ~ 2W	MM	105um	12VDC	FC/SMA	√	○	○
1570nm	WSLS-1570-005m-9-DC	0 ~ 5mW	SM	9um	5VDC	FC/SMA	√	○	○
	WSLS-1570-005m-PM-DC	0 ~ 5mW	PM	9um	5VDC	FC	√	○	○
1590nm	WSLS-1590-005m-9-DC	0 ~ 5mW	SM	9um	5VDC	FC/SMA	√	○	○
	WSLS-1590-005m-PM-DC	0 ~ 5mW	PM	9um	5VDC	FC	√	○	○
1610nm	WSLS-1610-005m-9-DC	0 ~ 5mW	SM	9um	5VDC	FC/SMA	√	○	○
	WSLS-1610-005m-PM-DC	0 ~ 5mW	PM	9um	5VDC	FC	√	○	○
1625nm	WSLS-1625-005m-9-DC	0 ~ 5mW	SM	9um	5VDC	FC/SMA	√	○	○

Note: √:Yes, ○:Optional, x:No.

Wavelength	Part Number	Output Power Range	Fiber Type	Fiber Core	Supply Voltage	Connector	TEC	Analog	TTL
1625nm	WLSL-1625-005m-PM-DC	0 ~ 5mW	PM	9um	5VDC	FC	√	○	○
1650nm	WLSL-1650-005m-9-DC	0 ~ 5mW	SM	9um	5VDC	FC/SMA	√	○	○
	WLSL-1650-005m-PM-DC	0 ~ 5mW	PM	9um	5VDC	FC	√	○	○
1720nm	WLSL-1720-001-M-DC	0 ~ 1W	MM	105um	12VDC	FC/SMA	√	○	○
1900nm	WLSL-1900-500m-M-DC	0 ~ 500mW	MM	105um	12VDC	FC/SMA	√	○	○
1920nm	WLSL-1920-500m-M-DC	0 ~ 500mW	MM	105um	12VDC	FC/SMA	√	○	○

Note: √:Yes, ○:Optional, ×:No.

D100 Package View :

131mm*90mm*33mm

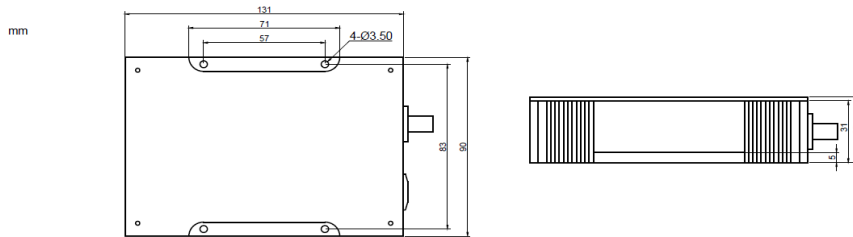

D200 Package View :

180mm*130mm*35mm

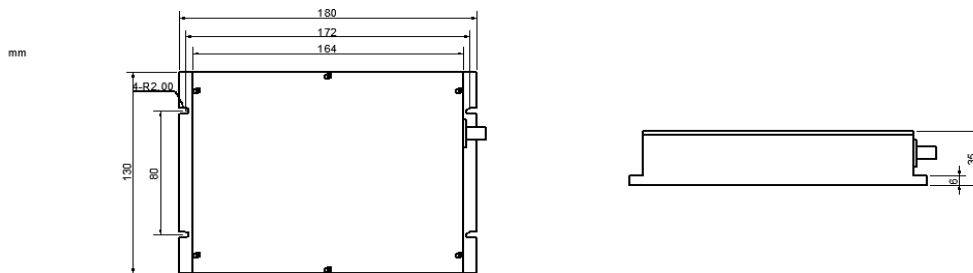

D300 Package View :

304mm*224mm*207mm

